



TUDOR

CLASSIC
WATCHES

SETTINGS

CLASSIC WATCHES



SETTINGS ADVISOR

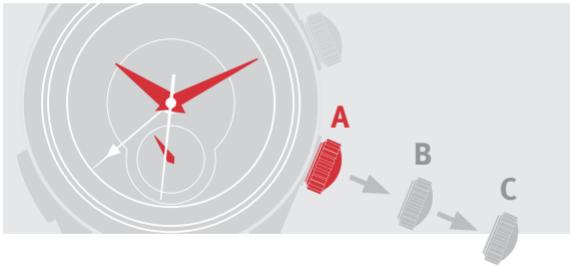

SCREWED-DOWN POSITION [position A]

➔ Advisor [crown not screwed-down]

Your TUDOR watch is equipped with a screw-down crown. Once this is fully screwed down against the case, your watch is guaranteed waterproof.

MANUAL WINDING [position B]

➔ Advisor [position A]

A watch equipped with a self-winding mechanical movement is wound automatically by wrist movements alone. To ensure optimum winding, wear your watch daily.

Before you first use the watch or if it has stopped, you will need to wind it manually by unscrewing the crown and then turning it clockwise; the other direction is inactive.

DATE-SETTING [position C]

➔ Advisor [position B]

In order to adjust the date, unscrew the crown and pull it out to the second notch.

› **For Advisor,** pull the crown out to the first notch.

Then turn it clockwise until the desired date appears in the window. The date is corrected when the hands pass midnight. During this operation, your watch will keep running.

› **For Advisor and North Flag:**
Turn the crown anticlockwise.

You are advised not to correct the date between 20:00 and 02:00. If the date is corrected between these times, the date will not change at midnight, but 24 hours later.

In order to adjust the day of the week, unscrew and pull the crown out to the second notch. Then turn it anticlockwise until the desired day appears in the window.

TIME-SETTING [position D]

➔ Advisor [position C]

In order to adjust the time, unscrew the crown and pull it out to the last notch. Then turn it in either direction until the hands indicate the correct time. The small seconds hand is stopped during this operation, allowing the time to be set accurately. To synchronize the small seconds hand and minute hand, the fine adjustment must be performed in an anticlockwise direction.

- › **For the models with date,** if the watch has stopped, take care not to confuse midday and midnight during this operation. Move the hands forward to 12 o'clock; if the date changes, then it is midnight.
- › **For Advisor,** in a time-setting operation, the hour hand drags the alarm hand anticlockwise when they are superposed.

ALARM FUNCTION

ON ADVISOR

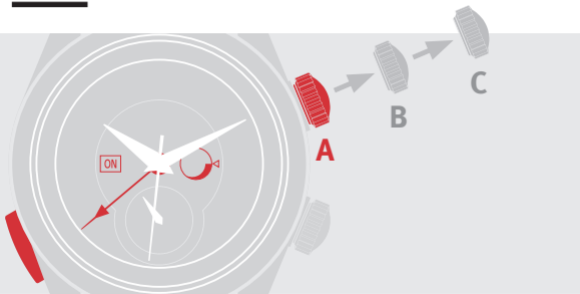

**BEFORE ACTIVATING THE ALARM,
[position B]**

- ① you will need to wind it manually by pulling out the alarm-setting crown at the first notch.
 - ② Then turn it clockwise. It is important not to overwind the crown.
- Once the mechanism is fully wound, the alarm power-reserve indicator is at the maximum level which corresponds to an approximately 10-second ring.
- ③

**IN ORDER TO ADJUST THE ALARM TIME,
[position C]**

pull out the alarm-setting mechanism to the last notch.
Then turn it clockwise until the alarm hand indicates
the desired time.

ACTIVATING THE ALARM

[pusher at 8 o'clock]

The alarm is activated or deactivated by simply pressing the alarm activating/deactivating pusher. Its status is indicated by the ON/OFF mention at 9 o'clock.

RECOMMENDATIONS

Bronze: Your Black Bay Bronze is designed in bronze, in this case a high-performance aluminium bronze alloy, which guarantees the development of a subtle and unique patina to match its user's habits.

Cleaning: Use a microfibre cloth and wash the metal, rubber, fabric bracelets and waterproof cases from time to time with a soft brush and soapy water. We recommend that you do not use abrasive or corrosive products (solvents, detergents, perfume, etc.).

Guarantee: Refer to the guarantee manual supplied with your watch.

Leather: To preserve your leather strap, we recommend protecting it from water and moisture.

PVD: Your Black Bay Dark is finished with a black coating obtained using a Physical Vapour Deposition (PVD) process. Although the coating is extremely resistant, regular wear and tear can cause this decorative layer to deteriorate over time. The warranty does not cover this type of aesthetic wear.

Salt water: Always rinse your watch with fresh water.

Screw-down winding crown: After each operation, remember to push the crown back in and screw it back down carefully against the case, in order to preserve your watch's waterproofness.

Service: Each TUDOR watch is a complex precision mechanism and, as such, requires periodic servicing and maintenance to guarantee optimum performance. Expert TUDOR servicing can be carried out via any of the Official Retailers and Service Centres in the extensive ROLEX or TUDOR service network. Visit TUDORWATCH.COM to view the list of Official TUDOR Retailers and Service Centres in your area.

Strap: Only Official TUDOR Retailers are authorized to change the watch strap.

| REFERENCE | MODEL |
|-------------------|---------------------|
| 91650/91651 | TUDOR 1926 |
| 91550/91551 | TUDOR 1926 |
| 91450/91451 | TUDOR 1926 |
| 91350/91351 | TUDOR 1926 |
| 91210N | NORTH FLAG |
| 79910 | HERITAGE RANGER |
| 79540/79500/79580 | BLACK BAY 41/36/32 |
| 79620T/TC/TN | HERITAGE ADVISOR |
| 57100/57103 | GLAMOUR DOUBLE DATE |

CALIBRE

POWER RESERVE

WATERPROOFNESS

2824

38 h

100 m

2824

38 h

100 m

2824

38 h

100 m

2671

38 h

100 m

MT5621

70 h

100 m

2824

38 h

150 m

2824

38 h

150 m

2892

42 h

100 m

MT5641

70 h

100 m

| REFERENCE | MODEL |
|-------------|------------------|
| 56000/56003 | GLAMOUR DATE+DAY |
| 55000/55003 | GLAMOUR DATE |
| 55020/55023 | GLAMOUR DATE |
| 53000/53003 | GLAMOUR DATE |
| 53020/53023 | GLAMOUR DATE |
| 51000/51003 | GLAMOUR DATE |
| 35800 | CLAIR DE ROSE |
| 35500/35200 | CLAIR DE ROSE |
| 23010/23013 | CLASSIC DATE+DAY |

CALIBRE

POWER RESERVE

WATERPROOFNESS

2834

38 h

100 m

2824

38 h

100 m

2824

38 h

100 m

2671

38 h

100 m

2671

38 h

100 m

2671

38 h

100 m

2824

38 h

100 m

2671

38 h

100 m

2834

38 h

100 m

| REFERENCE | MODEL |
|-------------|--------------|
| 21010/21013 | CLASSIC DATE |
| 21020/21023 | CLASSIC DATE |
| 22010/22013 | CLASSIC DATE |
| 22020/22023 | CLASSIC DATE |
| 12700/12703 | STYLE |
| 12710/12713 | STYLE |
| 12500/12503 | STYLE |
| 12510/12513 | STYLE |
| 12300/12303 | STYLE |

CALIBRE

POWER RESERVE

WATERPROOFNESS

2824

38 h

100 m

2824

38 h

100 m

2671

38 h

100 m

2671

38 h

100 m

2824

38 h

100 m

2824

38 h

100 m

2824

38 h

100 m

2824

38 h

100 m

2824

38 h

100 m

| REFERENCE | MODEL |
|-------------------|-----------------|
| 12310/12313 | STYLE |
| 12100/12103 | STYLE |
| 12110/12113 | STYLE |
| 76200/76213/76214 | PRINCE DATE+DAY |
| 74000/74033/74034 | PRINCE DATE |
| 72000/72033/72034 | PRINCE DATE |
| 92400/92413/92414 | PRINCESS DATE |
| 92500/92513/92514 | PRINCESS DATE |

CALIBRE

POWER RESERVE

WATERPROOFNESS

2824

38 h

100 m

2671

38 h

100 m

2671

38 h

100 m

2834

38 h

100 m

2824

38 h

100 m

2824

38 h

100 m

2671

38 h

100 m

2671

38 h

100 m



TUDOR

© Montres TUDOR SA
Rue François-Dussaud 3-5-7
1211 Geneva 26, Switzerland

TUDORWATCH.COM

Montres TUDOR SA reserves the right to modify the models illustrated in this publication at any time.

IMT-CL-EN-18 – 9.2018

VISIT TUDORWATCH.COM
AND EXPLORE MORE
