



TUDOR

CLASSIC
WATCHES

SETTINGS

CLASSIC WATCHES



SETTINGS ADVISOR

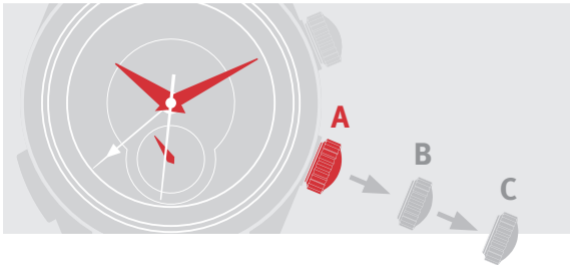

SCREWED-DOWN POSITION [position A]

➔ Advisor [crown not screwed-down]

Your TUDOR watch is equipped with a screw-down crown. Once this is fully screwed down against the case, your watch is guaranteed waterproof.

MANUAL WINDING [position B]

➔ Advisor [position A]

A watch equipped with a self-winding mechanical movement is wound automatically by wrist movements alone. To ensure optimum winding, wear your watch daily.

Before you first use the watch or if it has stopped, you will need to wind it manually by unscrewing the crown and then turning it clockwise; the other direction is inactive.

DATE-SETTING [position C]

➔ **Advisor [position B]**

In order to adjust the time, unscrew the crown and pull it out to the last notch.

› **For Advisor**, pull the crown out to the first notch.

Then turn it clockwise until the desired date appears in the window. The date is corrected when the hands pass midnight. During this operation, your watch will keep running.

› **For Advisor and North Flag:**
Turn the crown counterclockwise.

You are advised not to correct the date between 20:00 and 02:00. If the date is corrected between these times, the date will not change at midnight, but 24 hours later.

In order to adjust the day of the week, unscrew and pull the crown out to the second notch. Then turn it counterclockwise until the desired day appears in the window.

TIME-SETTING [position D]

➔ Advisor [position C]

In order to adjust the time, unscrew the crown and pull it out to the last notch. Then turn it in either direction until the hands indicate the correct time. The small second hand is stopped during this operation, allowing the time to be set accurately. To synchronize the small second hand and minute hand, the fine adjustment must be performed in a counterclockwise direction.

- › **For the models with date**, if the watch has stopped, take care not to confuse midday and midnight during this operation. Move the hands forward to 12 o'clock; if the date changes, then it is midnight.
- › **For Advisor**, in a time-setting operation, the hour hand drags the alarm hand counterclockwise when they are superposed.

ALARM FUNCTION

ON ADVISOR

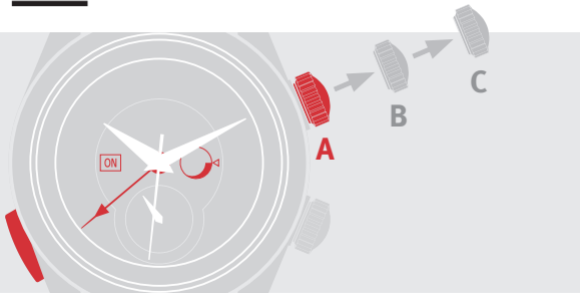

**BEFORE ACTIVATING THE ALARM,
[position B]**

- ① you will need to wind it manually by pulling out the alarm-setting crown at the first notch.
- ② Then turn it clockwise. It is important not to overwind the crown.

Once the mechanism is fully wound, the alarm power-reserve indicator is at the maximum level which corresponds to an approximately 10-second ring.

③

**IN ORDER TO ADJUST THE ALARM TIME,
[position C]**

pull out the alarm-setting mechanism to the last notch.
Then turn it clockwise until the alarm hand indicates the
desired time.

ACTIVATING THE ALARM

[pusher at 8 o'clock]

The alarm is activated or deactivated by simply pressing the alarm activating/deactivating pusher. Its status is indicated by the ON/OFF mention at 9 o'clock.

RECOMMENDATIONS

Bronze: Your Black Bay Bronze is designed in bronze, in this case a high-performance aluminum bronze alloy, which guarantees the development of a subtle and unique patina to match its user's habits.

Cleaning: Use a microfiber cloth and wash the metal, rubber, fabric bracelets and waterproof cases from time to time with a soft brush and soapy water. We recommend that you do not use abrasive or corrosive products (solvents, detergents, perfume, etc.).

Guarantee: Refer to the guarantee manual supplied with your watch.

Leather: To preserve your leather strap, we recommend protecting it from water and moisture.

PVD: Your Black Bay Dark is finished with a black coating obtained using a Physical Vapor Deposition (PVD) process. Although the coating is extremely resistant, regular wear and tear can cause this decorative layer to deteriorate over time. The warranty does not cover this type of aesthetic wear.

Salt water: Always rinse your watch with fresh water.

Screw-down winding crown: After each operation, remember to push the crown back in and screw it back down carefully against the case, in order to preserve your watch's waterproofness.

Service: Each TUDOR watch is a complex precision mechanism and, as such, requires periodic servicing and maintenance to guarantee optimum performance. Expert TUDOR servicing can be carried out via any of the Official Jewelers and Service Centers in the extensive ROLEX or TUDOR service network. Visit TUDORWATCH.COM to view the list of Official TUDOR Jewelers and Service Centers in your area.

Strap: Only Official TUDOR Jewelers are authorized to change the watch strap.

REFERENCE	MODEL
91650/91651	TUDOR 1926
91550/91551	TUDOR 1926
91450/91451	TUDOR 1926
91350/91351	TUDOR 1926
91210N	NORTH FLAG
79910	HERITAGE RANGER
79540/79500/79580	BLACK BAY 41/36/32
79620T/TC/TN	HERITAGE ADVISOR
57100/57103	GLAMOUR DOUBLE DATE

CALIBER

POWER RESERVE

WATERPROOFNESS

2824

38 h

100 m

2824

38 h

100 m

2824

38 h

100 m

2671

38 h

100 m

MT5621

70 h

100 m

2824

38 h

150 m

2824

38 h

150 m

2892

42 h

100 m

MT5641

70 h

100 m

REFERENCE	MODEL
56000/56003	GLAMOUR DATE+DAY
55000/55003	GLAMOUR DATE
55020/55023	GLAMOUR DATE
53000/53003	GLAMOUR DATE
53020/53023	GLAMOUR DATE
51000/51003	GLAMOUR DATE
35800	CLAIR DE ROSE
35500/35200	CLAIR DE ROSE
23010/23013	CLASSIC DATE+DAY

CALIBER

POWER RESERVE

WATERPROOFNESS

2834

38 h

100 m

2824

38 h

100 m

2824

38 h

100 m

2671

38 h

100 m

2671

38 h

100 m

2671

38 h

100 m

2824

38 h

100 m

2671

38 h

100 m

2834

38 h

100 m

REFERENCE	MODEL
21010/21013	CLASSIC DATE
21020/21023	CLASSIC DATE
22010/22013	CLASSIC DATE
22020/22023	CLASSIC DATE
12700/12703	STYLE
12710/12713	STYLE
12500/12503	STYLE
12510/12513	STYLE
12300/12303	STYLE

CALIBER

POWER RESERVE

WATERPROOFNESS

2824

38 h

100 m

2824

38 h

100 m

2671

38 h

100 m

2671

38 h

100 m

2824

38 h

100 m

2824

38 h

100 m

2824

38 h

100 m

2824

38 h

100 m

2824

38 h

100 m

REFERENCE	MODEL
12310/12313	STYLE
12100/12103	STYLE
12110/12113	STYLE
76200/76213/76214	PRINCE DATE+DAY
74000/74033/74034	PRINCE DATE
72000/72033/72034	PRINCE DATE
92400/92413/92414	PRINCESS DATE
92500/92513/92514	PRINCESS DATE

CALIBER

POWER RESERVE

WATERPROOFNESS

2824

38 h

100 m

2671

38 h

100 m

2671

38 h

100 m

2834

38 h

100 m

2824

38 h

100 m

2824

38 h

100 m

2671

38 h

100 m

2671

38 h

100 m



TUDOR

© 2018 TUDOR WATCH U.S.A., LLC
665 Fifth Avenue
New York, NY 10022

TUDORWATCH.COM

TUDOR Watch U.S.A., LLC reserves the right to modify the models illustrated in this publication at any time.

® Trademarks:

TUDOR, TUDORWATCH,  TUDOR, BLACK BAY, BLACK SHIELD, BORN TO DARE, CLAIR DE ROSE, PELAGOS, PELAGOS LHD, S&G, TUDOR ADVISOR, TUDOR FASTRIDER, TUDOR GLAMOUR, TUDOR HERITAGE, TUDOR HERITAGE RANGER, TUDOR NORTH FLAG, , , .

IMT-CL-US-18 – 9.2018

VISIT TUDORWATCH.COM
AND EXPLORE MORE
